

UNIT, DIRECT SUPPORT, AND GENERAL SUPPORT MAINTENANCE  
REPAIR PARTS AND SPECIAL TOOLS LIST

EXTENDED SERVICE PROGRAM (ESP)

TRUCK, CARGO, 2-1/2-TON, 6X6, M44A3 SERIES TRUCKS (DIESEL)

M35A3, W/O WINCH (NSN 2320-01-383-2047); W/WINCH (NSN 2320-01-383-3850);

M35A3C, W/O WINCH (NSN 2320-01-383-2050); W/WINCH (NSN 2320-01-383-2049);

M36A3, W/O WINCH (NSN 2320-01-383-2048); W/WINCH (NSN 2320-01-383-2046).

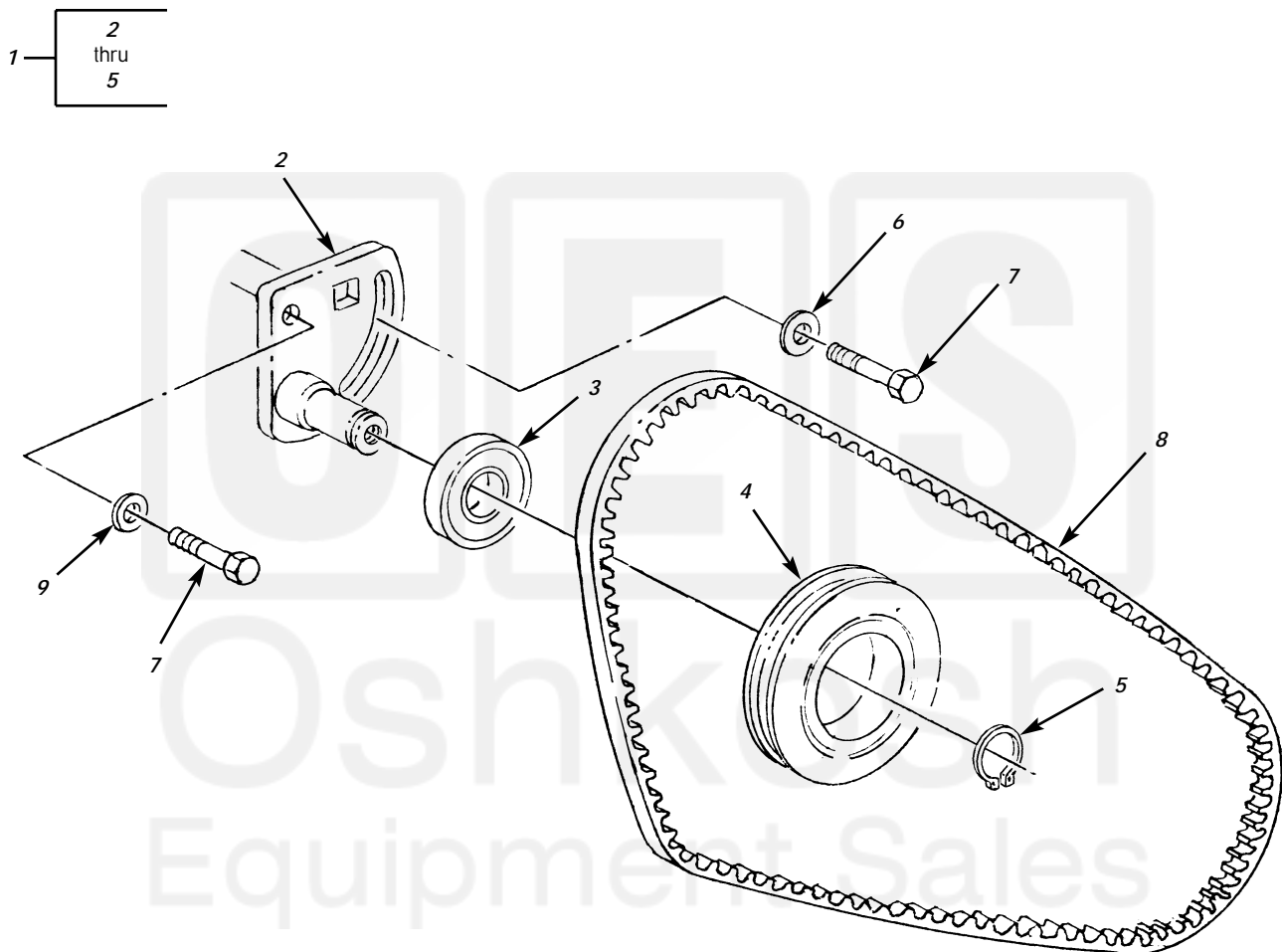

Figure 49. Water Pump Belt and Tensioner.

Current part is item (8) on diagram. Available at [www.oshkoshequipment.com](http://www.oshkoshequipment.com)

(1) ITEM NO	(2) SMR CODE	(3) NSN	TM9-2320-386-24P (4) CAGEC	(5) PART NUMBER	(6) DESCRIPTION AND USABLE ON CODES(UOC)	0050 00 (7) QTY
GROUP 0504 WATER PUMP						
FIG. 49 WATER PUMP BELT AND TENSIONER						
1	PAOOO	3020013606544	11083	1-1006268	PULLEY,GROOVE.....	1
2	XAOZZ		11083	1006267	.PLATE AS-IDLER.....	1
3	PAOZZ	3110014255658	11083	117-7114	.BEARING,BALL,ANNULA.....	1
4	PAOZZ	3020013606545	11083	1-1006299	.PULLEY,GROOVE.....	1
5	PAOZZ	5325013600957	11083	2L8509	.RING,RETAINING.....	1
6	PAOZZ	5310011639318	11083	4F3714	WASHER,FLAT.....	1
7	PAOZZ	5306013600929	11083	6V2317	BOLT,MACHINE.....	2
8	PAOZZ	3030013983367	11083	7E0744	BELT,V.....	1
9	PAOZZ	5310004324064	11083	9M1974	WASHER,FLAT.....	1

END OF FIGURE



0050 00-1

Current part is item (8) on diagram. Available at [www.oshkoshequipment.com](http://www.oshkoshequipment.com)